

Typical Fence and Construction Requirements

STREET 2

STREET 1

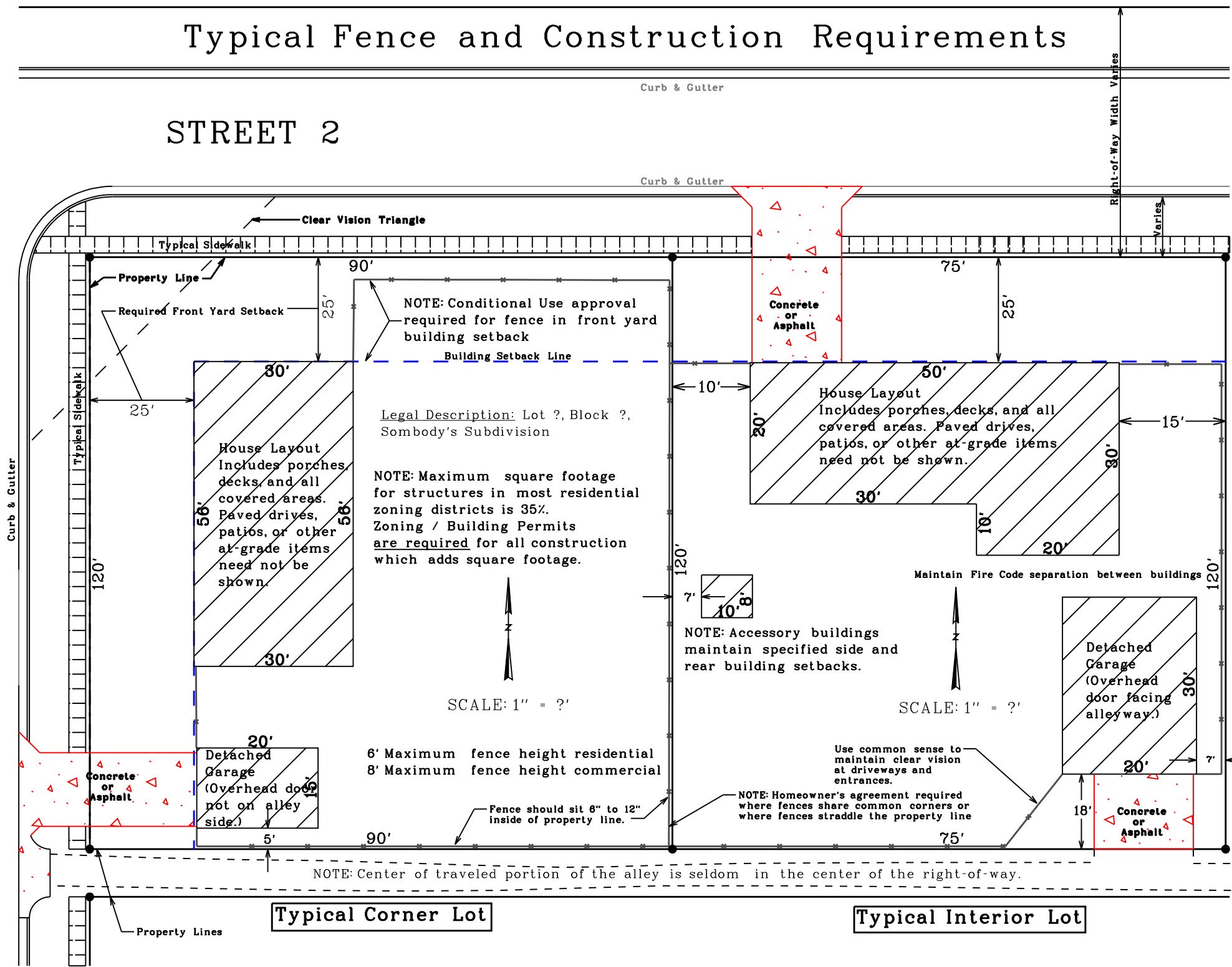

Curb & Gutter

Curb & Gutter

Right-of-Way Width Varies

Varies

Typical Sidewalk

Property Line
Required Front Yard Setback

90'

NOTE: Conditional Use approval required for fence in front yard building setback

Building Setback Line

Legal Description: Lot ?, Block ?, Sombody's Subdivision

NOTE: Maximum square footage for structures in most residential zoning districts is 35%. Zoning / Building Permits are required for all construction which adds square footage.

House Layout
Includes porches, decks, and all covered areas. Paved drives, patios, or other at-grade items need not be shown.

House Layout
Includes porches, decks, and all covered areas. Paved drives, patios, or other at-grade items need not be shown.

Maintain Fire Code separation between buildings

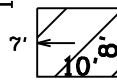

NOTE: Accessory buildings maintain specified side and rear building setbacks.

SCALE: 1" = 20'

SCALE: 1" = 20'

6' Maximum fence height residential
8' Maximum fence height commercial

Use common sense to maintain clear vision at driveways and entrances.

NOTE: Homeowner's agreement required where fences share common corners or where fences straddle the property line

Fence should sit 6" to 12" inside of property line.

NOTE: Center of traveled portion of the alley is seldom in the center of the right-of-way.

Typical Corner Lot

Typical Interior Lot

Property Lines